

Z900-A82

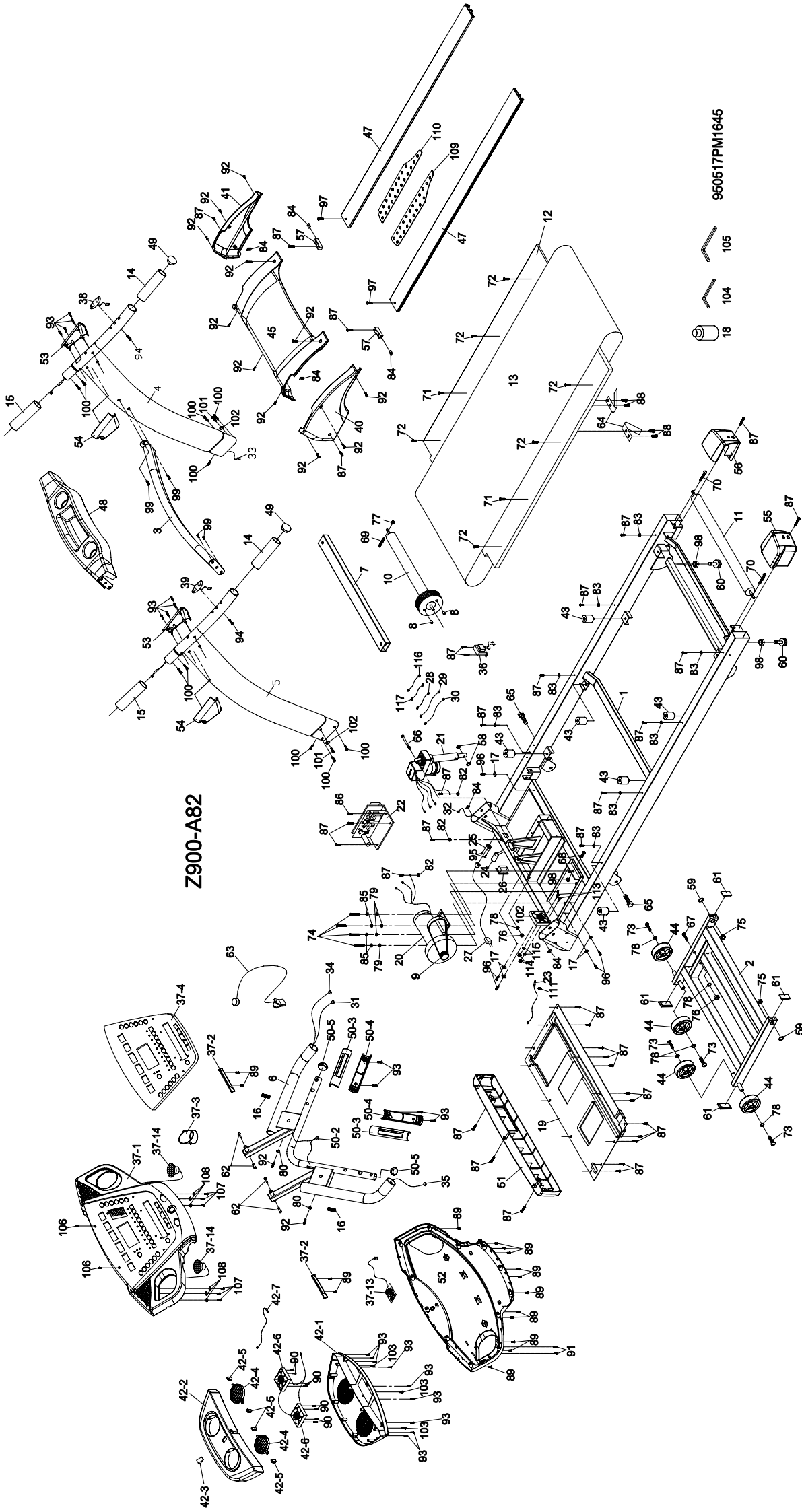

- 18 Nut
- 104 Bolt
- 105 Bolt

950517PM1645

UTT8 (588886) PARTS LIST

NO.	Description	Qty.
1	MAIN FRAME	1
2	INCLINE BRACKET	1
3	HANDRAIL SUPPORT	1
4	RIGHT HANDRAIL	1
5	LEFT HANDRAIL	1
6	CONSOLE SUPPORT	1
7	DECK CROSS BRACE	1
8	~10 MAGNET (SLUG IS SENT WITH MAGNET)	2
9	DRIVE BELT - 240J/610J	1
10	FRONT ROLLER W/ PULLEY	1
11	REAR ROLLER	1
12	RUNNING DECK	1
13	RUNNING BELT	1
14	HANDGRIP FOAM	2
15	CONSOLE SUPPORT FOAM	2
16	0.6T SPRING	2
17	WIRE TIE MOUNT	5
18	LUBRICANT	1
19	BOTTOM FRAME COVER	1
20	MOTOR - 3.5 Turdan	1
21	INCLINE MOTOR	1
22	CONTROLLER W/ FAN PLUG	1
23	SENSOR W/CABLE	1
24	BREAKER	1
25	POWER SOCKET	1
26	ON / OFF SWITCH	1
27	POWER CORD	1
28	100mm x 764 x 764 CONNECTING CABLE (BLACK)	1
29	150mm x 764 x 764 CONNECTING CABLE (WHITE)	1
30	150mm x 764 x 764 CONNECTING CABLE (BLACK)	1
31	800 m/m COMPUTER CABLE (UPPER)	1
32	800 m/m COMPUTER CABLE (LOWER)	1
33	1300 m/m COMPUTER CABLE (MIDDLE)	1
34	800 m/m SPEED CABLE (UPPER)	1
35	800 m/m INCLINE CABLE (UPPER)	1
36	TRANSFORMER	1
37	CONSOLE	1
37~1	TOP CONSOLE COVER	1
37~2	BOOK RACK	2

37~3	BEVERAGE HOLDER OF CONSOLE		1
37~4	FACE PLATE LENSE		1
37~13	AUDIO CABLE-SPEAKER AMP. HARNESS		1
37~14	SPEAKER		2
38	SPEED ADJUSTMENT SWITCH W/CABLE		1
39	INCLINE ADJUSTMENT SWITCH W/CABLE		1
40	FRAME BASE CAP (R)		1
41	FRAME BASE CAP (L)		1
42	FAN ASSEMBLY W/ TAB		1
42~1	BOTTOM FAN COVER		1
42~2	TOP FAN COVER		1
42~3	FAN SWITCH		1
42~4	DEFLECTOR FAN GRILL		2
42~5	FAN GRILL ANCHOR		4
42~6	FAN		2
42~7	300m/m POWER PLUG		1
43	M8 x ϕ 30 x 35 CUSHION - SOFTER		6
44	ϕ 81 X 35 WHEEL		4
45	TOP MOTOR COVER		1
47	FOOT RAIL		2
48	BEVERAGE HOLDER		1
49	ϕ 38 BUTTON HEAD END CAP		2
50	HANDPULSE ASSY.		2
50~2	650 m/m HANDPULSE CABLE		1
50~3	HANDPULSE ASSEMBLY TOP		2
50~4	HANDPULSE ASSEMBLY BOTTOM		2
50~5	HANDLE BAR END CAP		2
51	FRAME FRONT COVER		1
52	BOTTOM CONSOLE COVER		1
53-54	HANDGRIP SIDE CAP (L&R)		2
55	REAR ADJUSTMENT BASE (L)		1
56	REAR ADJUSTMENT BASE (R)		1
57	MOTOR COVER ANCHOR		2
58	ϕ 24 x ϕ 10 x 3T NYLON WASHER(A)		2
59	ϕ 50 x ϕ 13 x 3T NYLON WASHER (B)		4
60	ϕ 38 x 3/8" FOOT PAD		2
61	25 x 50 SQUARE END CAP		4
62	1/2 X 4(13m/m) BOLT CAP		4
63	SAFETY KEY		1
64	BELT GUIDE		2
65	1/2" x 57m/m HEX HEAD SCREW		2

66	3/8" x 4-1/2" SOCKET HEAD CAP SCREW		1
67	3/8" x 4" SOCKET HEAD CAP SCREW		1
68	3/8" x 1-3/4" HEX HEAD SCREW		1
69	M8 x 60m/m HEX HEAD SCREW		1
70	M8 x 80m/m SOCKET HEAD CAP SCREW		2
71	M8 x 55m/m FLAT HEAD COUNTERSINK SCREW		2
72	M8 x 35m/m FLAT HEAD COUNTERSINK SCREW		6
73	3/8" x 3/4" BUTTON HEAD SOCKET SCREW		4
74	3/8" x 1" HEX HEAD SCREW		4
75	1/2" x 15T NYLON NUT		2
76	3/8" x 7T NYLON NUT		2
77	M8 NYLON NUT		1
78	ϕ 19 x ϕ 10 x 1.5T FLAT WASHER		6
79	ϕ 25 x ϕ 10 x 1.5T FLAT WASHER		4
80	ϕ 5 x ϕ 15 x 1.0T FLAT WASHER		2
82	M5 RAISED WASHER		3
83	6.5 x 25 x 1.5T x 4.5H CONCAVE WASHER		8
84	M5 IRON PLATE NUT (Frame Base Caps)		6
85	ϕ 10 x 1.5T SPRING WASHER		4
86	5 x 19 m/m TAPPING SCREW		1
87	5 x 16 m/m TAPPING SCREW - BLACK		39
88	4x12 m/m SELF TAPPING SCREW		4
89	3.5x12 m/m SELF TAPPING SCREW		16
90	3.5x43 m/m SELF TAPPING SCREW		8
92	5 x 16 m/m TAPPING SCREW - BLACK		13
93	3x10 m/m TAPPING SCREW		21
94	4x38 m/m SELF TAPPING SCREW		2
95	3x10 m/m SELF TAPPING SCREW		2
96	3.5 x 16m/m TAPPING SCREW		5
98	3/8" NUT		3
99	5/16" x 3/4" BUTTON HEAD SOCKET SCREW		4
100	5/16" x 1/2" BUTTON HEAD SOCKET SCREW		10
101	3/8" x 2" BUTTON HEAD SOCKET SCREW		2
102	3/8" x 2T SPRING WASHER		2
103	M3 x 18 m/m TAPPING SCREW		3
104	COMBINATION M5 ALLEN WRENCH & SCREWDRIVER		1
105	M6 ALLEN WRENCH		1
106	3 x 10 m/m SELF TAPPING SCREW		2
107	3x 8 m/m SELF TAPPING SCREW		6
108	PLASTIC WASHER		6
109	NON-SLIP RUBBER(L)		1

110	NON-SLIP RUBBER(R)		1
111	SENSOR RACK		1
112	MOTOR FAN CONTROLLER FAN=000609		1
113	M4x35 m/m TAPPING SCREW		2
114	M4 NYLON NUT		2
115	ϕ 4 x ϕ 10 x 1.0T FLAT WASHER		2
116	250m/m_ BLACK CONNECTING CABLE OF MOTOR FAN		1
117	250m/m_ WHITE CONNECTING CABLE OF MOTOR FAN		1
	HARDWARE KIT	000614	1
	DECAL (CONSOLE)	000443	1
	DECAL (SIDE)	000444	2