

SZ510A-A923(SOLE)  
(F83)

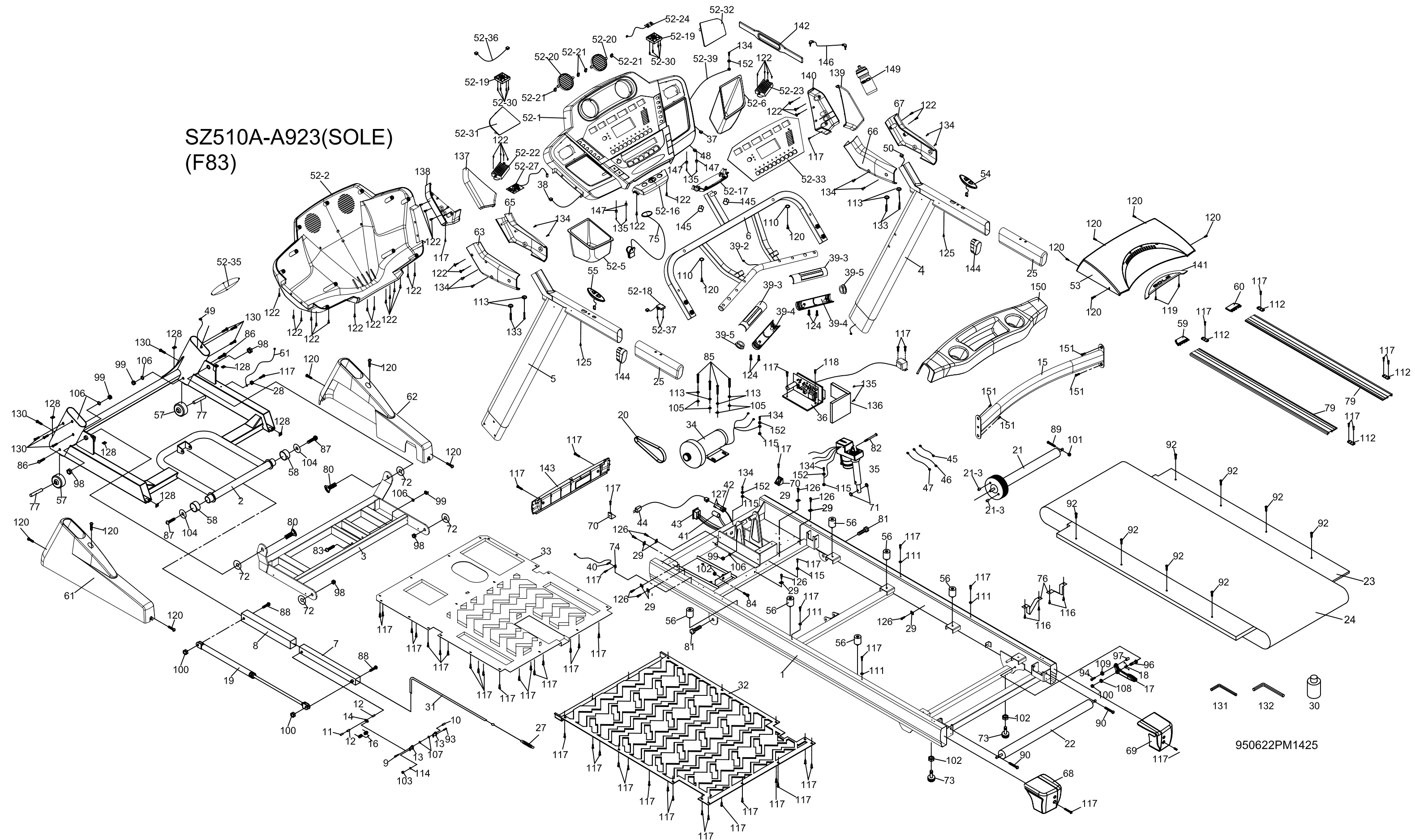

950622PM1425

## SOLE - WF83(583888) PARTS LIST

Dyaco #	Description	Spirit #	Qty
2	Frame Base	003015	1
3	Incline Bracket	003160	1
4	Right Handrail	003146	1
5	Left Handrail	003159	1
6	Console Support	003109	1
7	Locking Cable Assembly	022649	1
15	Handrail Support	003156	1
17	Release Lever - Clenching Handle	000506	1
19	Cylinder - 1000N	023095	1
20	Drive Belt - 240J/610J	022553	1
21	Front Roller W/Pulley	022694	1
21~3	~10 Magnet	000507	2
22	Rear Roller	022753	1
23	1375 x 614 x 25mm Running Deck	000491	1
24	510 x 3110 x 25mm Running Belt	000952	1
25	36x76x3Tx261L_Handle Bar Foam	003001	2
28	ψ1/4" _Wire Clamp	020457	1
29	Wire Tie Mount	010083	8
30	Lubricant	022271	1
31	Steel Rope - Locking cable only (880mm)	003031	1
32	Top Frame Cover	000969	1
33	810 x 675 Bottom Frame Cover	003161	1
34	Motor (3.0hp YC) red/white=650mm	003164	1
35	Incline Motor	022696	1
36	Controller	022670	1
36a	External Transformer for Controller	022791	1
37	800mm_Speed Cable (Upper)	022754	1
38	800mm_Incline Cable (Upper)	022755	1
39	Handpulse Assembly	022672	2
40	1200 m/m_Sensor W/Cable	022552	1
41	Breaker	022448	1
42	Power Socket	022658	1
43	On/Off Switch	022476	1
44	Power Cord	022812	1
45	100mm_Connecting Wires (Black)	000321	1
46	300mm_Connecting Wires (White)	000320	1
47	300mm_Connecting Wires (Black)	000319	1
48	800mm_Computer Cable (Upper)	022720	1
49	1150mm_Computer Cable (Lower)	022721	1
50	1100mm_Computer Cable (Middle)	000406	1
51	1000m/m_Ground Wire	003002	1
52	Console Assembly 2010 SN: 5838881001001962~2035	004278	1
52~1	Top Console Cover	003067	1
52~2	Bottom Console Cover	003070	1
52~5	Beverage Holder (L)	003072	1
52~6	Beverage Holder (R)	003073	1
52~16	Front Console Cover (Top)	003056	1
52~17	Front Console Cover (Bottom)	003057	1
52~18	300mm_Safety Switch Module W/ Cable	003020	1
52~19	Fan	003066	2
52~20	Deflector Fan Grill	000983	2
52~21	Console Anchor (Fan Grill Anchor)	000807	4
52~22	700mm_Speaker	003062	1
52~23	250mm_Speaker	003063	1
52~24	Amplifier	003064	1
52~27	Receiver, HR Assembly	022804	1
52~30	3.5 x32m/m_Self Tapping Screw	000914	8
52~31	Speaker Iron Net (L)	003106	1
52~32	Speaker Iron Net (R)	003107	1
52~33	Face Plate Lens Cover	004297	1
52~35	Badge, Console (Bottom Console Badge)	003076	1
52~36	Power Cord Of Amplifier	003065	1
52~37	3x10mm_Self Tapping Screw	023082	2
52~39	400mm Console Ground Wire	005013	1
53	Top Motor Cover	000931	1
54	300mm_Speed Adjustment Switch W/Cable	003068	1
55	300mm_Incline Adjustment Switch W/Cable	003069	1
56	M8 x 30 x B17535 Deck Cushion	030060	6
57	ψ75x35L_Transportation Wheel (A)	022479	2
58	ψ62 x ψ32 x 30L_Transportation Wheel (B)	000127	2
59	Foot Rail Cap (L)	000603	1
60	Foot Rail Cap (R)	000604	1
61	Frame Base Cap (L)	003042	1
62	Frame Base Cap (R)	003043	1
63	Left Handgrip Side Cap (L) (LL)	003005	1
65	Left Handgrip Side Cap (R) (LR)	003006	1
66	Right Handgrip Side Cap (L) (RL)	003007	1
67	Right Handgrip Side Cap (R) (RR)	003008	1
68	Rear Adjustment Base (L)	000925	1
69	Rear Adjustment Base (R)	000926	1
70	Motor Cover Anchor	022484	2
71	ψ10 x ψ24 x 3T_Nylon Washer (A)	023214	2
72	ψ50 x ψ13 x 3T_Nylon Washer (B)	023215	4
73	ψ30x 3/8" _Foot Pad	022713	2
74	Sensor Rack	022989	1
75	800mm_Ellipse Safety Key	003023	1
76	Belt Guide	000595	2
77	ψ14 xψ10 x 35.5L_Front Wheel Sleeve	023101	2
79	Foot Rail	000531	2
80	1/2" x 1-1/4" _Carriage Bolt	007086	2
81	1/2" x 1" _Hex Head Screw	003083	2
82	3/8" x 4-1/2" _Socket Head Cap Screw	000580	1
83	3/8" x 3-3/4" _Button Head Socket Screw	007112	1
84	3/8" x 1-1/2" _Hex Head Screw	000062	1
85	3/8" x 1" _Hex Head Screw	000061	4
86	3/8" x 2" _Thumb Head Socket Screw	022885	2
87	5/16" x 1" _Button Head Socket Screw	000125	2
88	5/16" x 2-3/4" _Button Head Socket Screw	022314	2
89	M8 x 60m/m_Hex Head Screw	030025	1
90	M8 x 80m/m_Socket Head Cap Screw	023022	2
92	M8 x 35m/m_Flat Head Countersink Screw	030020	8
93	M3 x 10m/m_Phillips Head Screw	030019	1
94	M5 x 20m/m_Phillips Head Screw	007114	1
96	5/16" x 42 m/m_Phillips Head Screw	007115	1
97	M5_Nyloc Nut	007096	1
98	1/2" x 8T_Nyloc Nut	023102	4
99	3/8" x 7T_Nyloc Nut	000080	4
100	5/16" x 6T_Nyloc Nut	030039	3
101	M8x 8T_Nyloc Nut	004064	1
102	3/8" x 6.5T_Nut	010125	3
103	M3_Nut	007124	1
104	ψ35 x ψ5/16" x 1.5T_Flat Washer	010099	2
105	ψ25 x ψ10 x 1.5T_Flat Washer	007116	4
106	ψ19 x ψ10 x 1.5T_Flat Washer	003116	4
107	ψ5 x ψ10 x 1.0T_Flat Washer	007117	2
108	ψ5/16" x ψ18 x 1.5T_Flat Washer	000077	1
109	ψ5 x ψ12 x 1.0T_Flat Washer	007118	1
110	ψ5 x ψ15 x 1.0T_Flat Washer	006148	2
111	ψ6xψ23xψ13x5.5Tx3T_Nylon Dished Washer	023128	4
112	ψ5.5 x 27x 60 x 1.0Tx2.5H_Concave Washer	003143	4
113	ψ10 x2T_Split Washer	000053	8
114	M3_Split Washer	007121	1
115	M5_Raised Washer	007122	4
116	4x12m/m_Self Tapping Screw	000070	4
117	5x16m/m_Tapping Screw	010110	58
118	5x19m/m_Tapping Screw	030057	1
119	3.5 x 6 m/m_Self Tapping Screw	023126	2
120	5 x 16m/m_Tapping Screw	010110	13
122	3.5 x 12 m/m_Self Tapping Screw	010113	35
124	3x10 m/m_Tapping Screw	023082	4
125	4x50m/m_Self Tapping Screw	003122	2
126	3.5 x 16 m/m_Tapping Screw	022979	8
127	3 x 10 m/m_Self Tapping Screw	023082	2
128	M5_Speed Nut	010109	6
130	5/16" x 1/2" _Button Head Socket Screw	003078	8
131	M5_Short Phillips Head Screw Driver	023109	1
132	M6_Allen Wrench	022973	1
133	3/8"x1-3/4" _Button Head Socket Screw	000067	4
134	M5x10mm_Phillips Head Bolt	004264	12
135	3x8mm_Self Tapping Screw	007125	6
136	Controller Back Plate	007168	1
137	Left Connecting Cap (Top)	003051	1
138	Left Connecting Cap (Bottom)	003052	1
139	Right Connecting Cap (Top)	003053	1
140	Right Connecting Cap (Bottom)	003054	1
141	Top Motor Cover Plate	003048	1
142	Chest Strap	022945	1
143	Front Motor Cover	000924	1
144	Ellipse End Cap	003025	2
145	13mm_Bolt Cap	003024	2
146	400mm_Audio Cable	004000	1
147	ψ12x5.5T_Plastic Washer	003108	4
149	Drink Bottle (SOLE Logo)	000844	1
150	Beverage Holder SN: 5838881001001962~2035	002234	1
151	5/16"x3/4" _Button Head Socket Screw (Plated)	022523	4
152	M5 x 1.5T_Split Washer	003167	4
	Upper Display	003141	1
	Hardware Kit	003003	1
	Poly Sticker (Console)	003203	1
	Lower Board	004117	1
	Button Overlay	004296	1
	Poly Sticker (Side)	003202	2
	"STOP" Button Board	003148	1
	"START" Button Board	003149	1