

ST90-YT007
SOLE-Sears(美國)

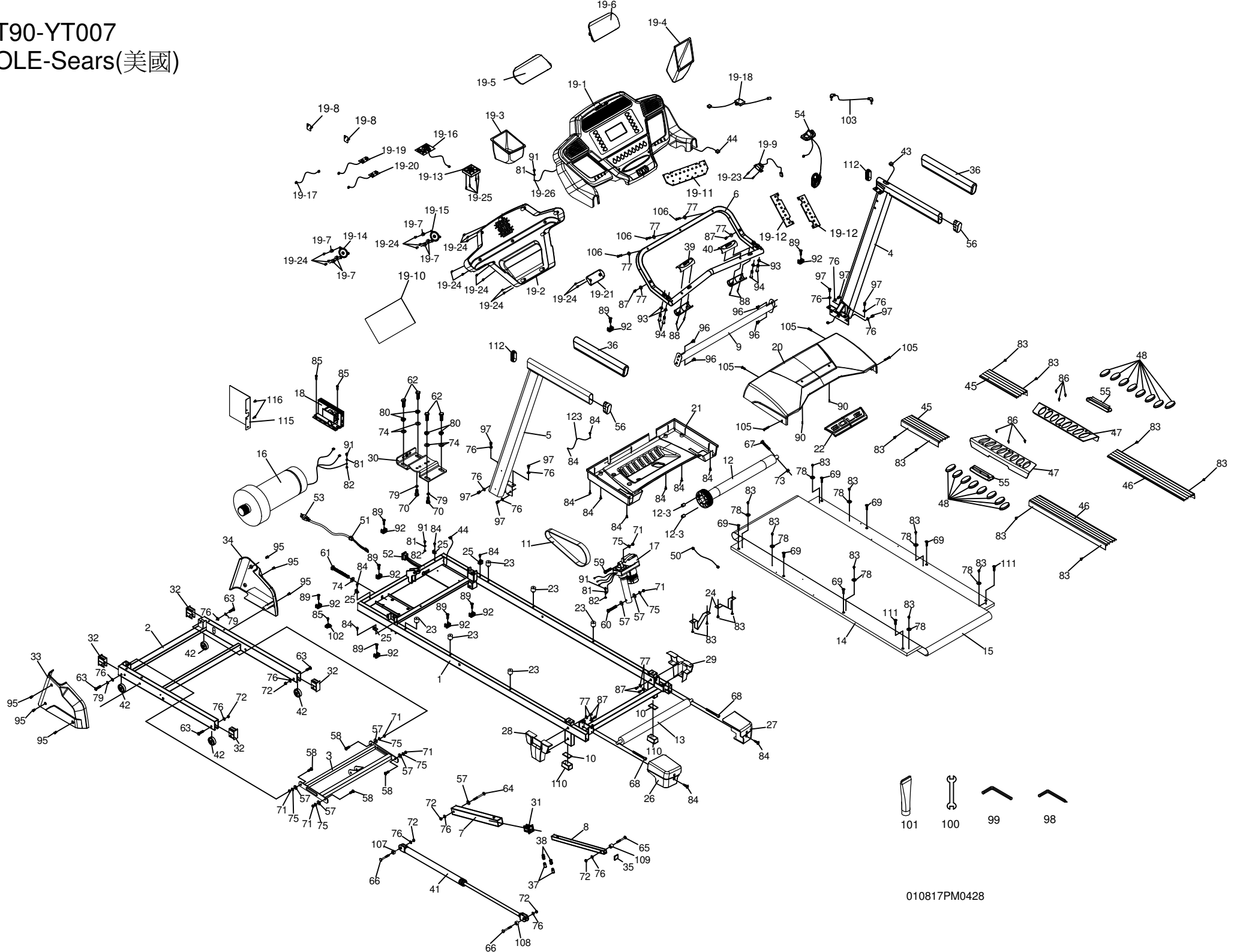

010817PM0428

SOLE - F60-560012 - PARTS LIST

Dyaco#	Material#	Detailed Descriptions	QTY
1	AA010039	Main Frame	1
2	AA020017	Frame Base	1
2	RAA020017-Q2	Frame Base Assembly	1
3	AA030011	Incline Bracket	1
4	AA040058	Right Upright	1
4	RAA040058-Q2	Right Upright Assembly	1
5	AA040051	Left Upright	1
5	RAA040051-Q2	Left Upright Assembly	1
6	AA050021	Console Support	1
7	AA060036	Outer Slide	1
8	A210023	Inner Slide-□21.4x21.4x1.8Tx430L	1
7+8	RAA060036-Q2	Outer + Inner Slide Assembly	1
9	AA060042	Handrail Support	1
10	B010056	Foot Pad Plate-25x50x2.0T	2
11	N011007	Drive Belt-6J190	1
12	K140079	Front Roller W/Pulley-Ø46×627L	1
13	K140080	Rear Roller-Ø46×540L	1
14	H140038	Running Deck-1410x700x18T	1
15	H06L3160-P5	Running Belt-510x3160x1.4T	1
16	G020119-02	Motor-YA247B/Ø32/1.5HP/5400rpm/90V Label : 2.75HP	1
17	G110061	Incline Motor-JS15A,N30128L,115V,350mm	1
18	D020100	Controller-YJ-AE0000L/110V	1
19	RZ4YT007A-20	Console Assembly	1
19~1	P020361A	Console Top Cover	1
19~2	P020362	Console Bottom Cover	1
19~3	P220033	Drink Bottle Holder (L)	1
19~4	P220034	Drink Bottle Holder (R)	1
19~5	B130176	Speaker Iron Net (L)	1
19~6	B130177	Speaker Iron Net (R)	1
19~7	P060223	Fan Grill Anchor	6
19~8	B130062	Square Magnet Stop Plate-20x14.8x7x0.3T	2
19~9	F030212	300m/m_Safety Switch Module W/Cable	1
19~10	D021137	Console Display Board-YJ-51070	1
19~11	D021138	Key Board-YJ-51070-K1	1
19~12	D021139	Key Fast Board-YJ-51070-K2	2
19~13	F040004	Fan-TFD-8025H12Z+400mm+XHP-4	1
19~14	F050023	300m/m_Speaker W/Cable	1
19~15	F050024	750m/m_Speaker W/Cable	1
19~16	F110205	Amplifier Controller-PA-YJ8511	1
19~17	E060504	300m/m_Amplifier Cable	1
19~18	D020501	300m/m_W/Receiver, HR	1
19~19	D020533	500m/m_Sound Board W/Cable	1
19~20	D020534	500m/m_Sound Board W/Cable	1
19~21	P020363	Safety Key Cover	1
19~23	J397003	3 × 10m/m_Sheet Metal Screw	2

19~24	J396804-Y3	3.5 × 12m/m_Sheet Metal Screw	21
19~25	J396811-Y3	3.5 × 32m/m_Sheet Metal Screw	4
19~26	E040037	500m/m_Console Ground Wire	1
20	P010118	Motor Top Cover	1
20	RP010118-A1	Motor Top Cover+ Cover Plate	1
21	P010119	Motor Bottom Cover	1
22	P010120	Top Motor Cover Plate	1
23	P060294	Rubber Foot-M6xØ25x22T	6
24	B133000	Belt Guide-55m/m	2
25	P060181	Motor Cover Anchor-20x20x18	4
26	P030096	Rear Adjustment Base (L)	1
27	P030097	Rear Adjustment Base (R)	1
28	P030098	Rear Foot Cover (L)	1
29	P030099	Rear Foot Cover (R)	1
30	AA060058	Motor Bracket	1
31	P040131	Inner Slide End Cap	1
32	P040132	Transportation Wheel End Cap	4
33	P030096	Frame Base Cover (L)	1
34	P030097	Frame Base Cover (R)	1
35	P040041	21.4 × 21.4m/m_Square End Cap	1
36	L030016	PVC Handgrip-Ø36×76×3.0T×410L	2
37	P060552-A1	Spring Sleeve	2
38	K010046	Constrict Spring	2
39	F090240	1000m/m_Handpulse W/Cable Assembly (White)	1
40	F090241	1000m/m_Handpulse W/Cable Assembly (Red)	1
41	K060023	GU22-700-500-30	1
42	P050010	Transportation Wheel- Ø48x18L	4
43	E020052	1200m/m_Computer Cable (Middle)	1
44	E020002	800m/m_Computer Cable (Upper/Lower)	2
45	P080018C-A1	300m/m_Foot Rail	2
46	P080018G-A1	715m/m_Foot Rail	2
47	P130001	Pedal Cover (Top)	2
48	P130002	Pedal Cover (Bottom)	16
49		350m/m_Connecting Wire (White)	0
50	E010801	350m/m_Connecting Wire (Black)	1
51	P060269	Grommet	1
52	F030004	On/Off Switch	1
53	E060082	Power Cord	1
54	N100013	800m/m_Trapezoidal Safety Key	1
55	P060530	Cushion Spacer	2
56	P040019	Handgrip End Cap	2
57	P060221	Ø10 × Ø24 × 3T_Nylon Washer	7
58	J021002	3/8" × 3/4" _Button Head Socket Bolt	4
59	J011007P-Y1	3/8" × 1-3/4" _Hex Head Bolt	1
60	J011010A-ZC	3/8" × 2-1/2" _Hex Head Bolt	1
61	J011011-Y3	3/8" × 2-3/4" _Hex Head Bolt	1
62	J011002-Y3	3/8" × 3/4" _Hex Head Bolt	4
63	J340506-Y3	5/16" × 1-1/2" _Flat Head Socket Bolt	4

64	J070513T-Y3	5/16" × 3-1/4" _Carriage Bolt	1
65	J070512T-Y3	5/16" × 3" _Carriage Bolt	1
66	J070529T-Y3	5/16" × 65m/m _Carriage Bolt	2
67	J013012-Y3	M8 × 60m/m _Hex Head Bolt	1
68	J033016-Y3	M8 × 80m/m _Socket Head Cap Bolt	2
69	J042505-Y3	M6 × 25m/m _Flat Head Countersink Bolt	6
70	J013002-Y3	M8 × 12m/m _Hex Head Bolt	2
71	J139011-Y3	3/8" _Nyloc Nut	6
72	J139062-Y3	5/16" _Nyloc Nut	6
73	J139261-Y3	M8 _Nyloc Nut	1
74	J210008-Y3	Ø25 × Ø10 × 2.0T _Flat Washer	5
75	J210003-Y3	Ø19 × Ø10 × 1.5T _Flat Washer	6
76	J210005-Y3	Ø5/16" × Ø18 × 1.5T _Flat Washer	16
77	J210017-Y3	Ø1/4" × 19 × 1.5T _Flat Washer	9
78	B130016-Z1	Ø6.5 × Ø25 × 1.5T _Concave Washer	8
79	J260007-Y3	M8 _Split Washer	4
80	J260004-Y3	Ø10 _Split Washer	4
81	J260008-Y3	M5 _Split Washer	4
82	J270001-Y3	M5 _Star Washer	3
83	J386904-Y3	4 × 12m/m _Sheet Metal Screw	20
84	J367105-Y3	5 × 16m/m _Tapping Screw	14
85	J367114-Y3	5 × 19m/m _Tapping Screw	3
86	J396806-Y3	3.5 × 18m/m _Sheet Metal Screw	6
87	J377105-Y3	5 × 16m/m _Tapping Screw	6
88	J517007-Y3	3 × 20m/m _Tapping Screw	4
89	J536805-Y3	3.5 × 16m/m _Tapping Screw	8
90	J397002-Y3	3 × 8m/m _Sheet Metal Screw	2
91	J092001-Y3	M5 × 10m/m _Phillips Head Screw	4
92	P060281	Wire Tie Mount	8
93	J260004-Y3	Ø10 _Split Washer	4
94	J021006-Y3	3/8" × 1-1/2" _Button Head Socket Bolt	4
95	J092003-Y3	M5 × 15m/m _Phillips Head Screw	6
96	J020502-Y3	5/16" × 3/4" _Button Head Socket Bolt	4
97	J010501-Y3	5/16" × 1/2" _Hex Head Bolt	8
98	J330001-Y3	Combination M5(25 × 90mm) Allen Wrench & Phillips Head Screw Driver	1
99	J330002-Y3	M6(68 × 88) _Allen Wrench	1
100	J330014	13m/m _Wrench	1
101	N020001	Lubricant	1
102	F030184	1200m/m _Speed Sensor W/Wire	1
103	E090001	400m/m _Audio Cable	1
105	J377110-Y3	5 × 30m/m _Tapping Screw	4
106	J377112-Y3	5 × 35m/m _Tapping Screw	3
107	C070112	Ø8.2 × Ø12.7 × 6.5L _Space Sleeve (A)	1
108	C070025	Ø8.2 × Ø12.7 × 11.5L _Shaft Bushing	1
109	C070114	Ø8.2 × Ø12.7 × 16L _Space Sleeve (C)	1
110	P040130	Square End Cap	2
111	J043005-Y3	M8 × 25m/m _Flat Head Countersink Bolt	2
112	P040137	Oval End Cap	2

115	B070005-Z1	Controller Back Plate	1
116	J397002-Y3	3 × 8m/m_Sheet Metal Screw	2
117		47 × 54.5 × 1.0T_Rear Roller Cover (L)	1
118		47 × 54.5 × 1.0T_Rear Roller Cover (R)	1
123	E040005	1000m/m_Ground Wire	1
X	I050339A	Poly sticker on side cover (sole F60)	2
X	I050339	Console Poly sticker (sole F60)	1
X	I030188	Console overlay	1
X	I900055-A1	Cartons (Top)	1
X	J99A0120	Guest Assembly screw	1