

# ST520-YT50-SOLE SEARS

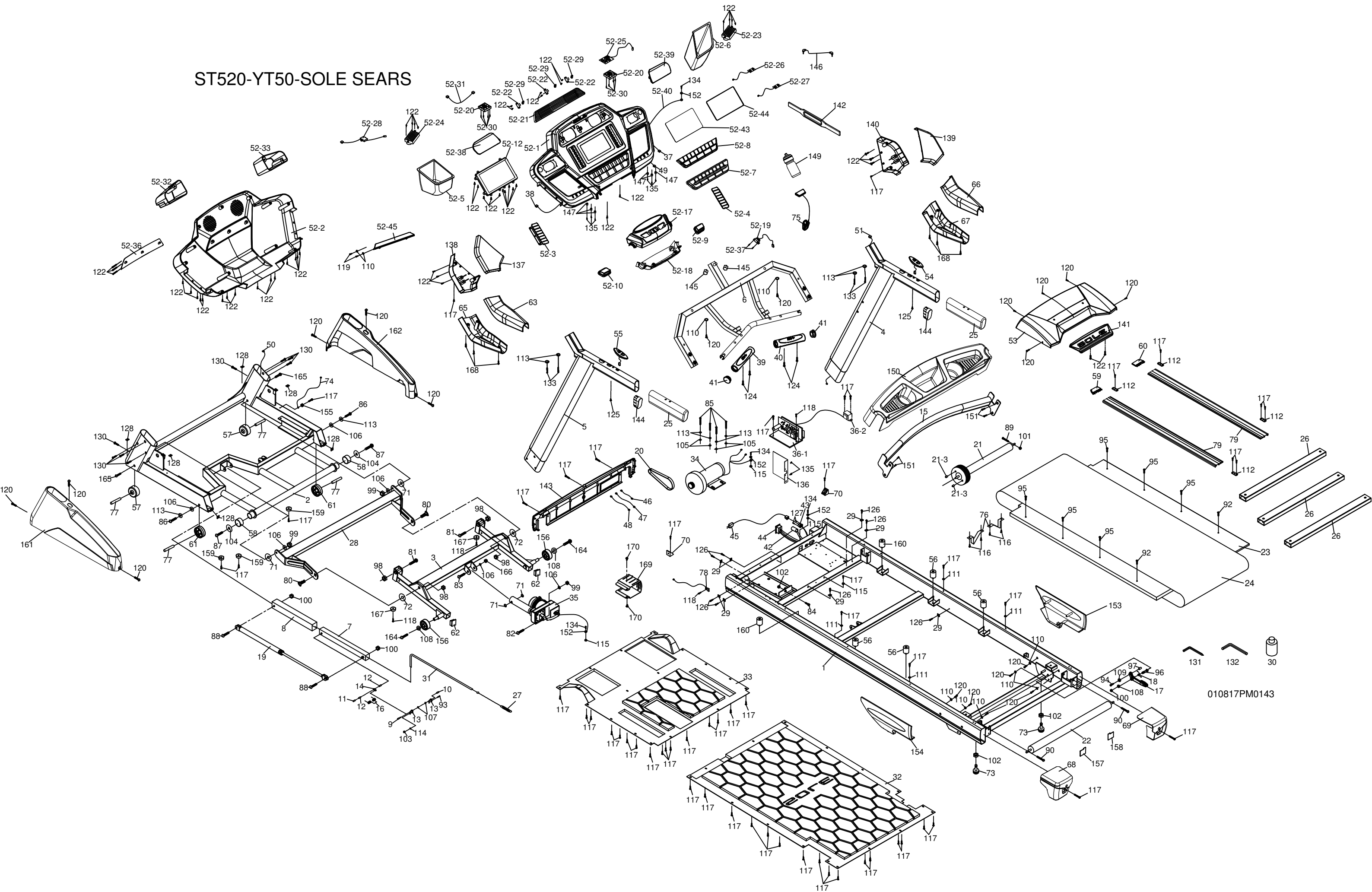

010817PM0143

# SOLE - F80-580812 - PARTS LIST

Dyaco #	Material #	Detailed Descriptions	QTY
1	AA010106-Q2	Main Frame	1
2	AA020027-Q2	Frame Base	1
2	RAA020027-Q2	Frame Base assembly	1
3	AA030020-Q2	Incline Bracket	1
3	RAA030020-Q2	Incline Bracket assembly	1
4	AA040066-Q2	Right Upright	1
4	RAA040066-Q2	Right Upright assembly	1
5	AA040059-Q2	Left Upright	1
5	RAA040059-Q2	Left Upright assembly	1
6	AA050028-Q2	Console Support	1
7	AA060002-Z2	Inner Slide	1
8	AA060001-Q2	Outer Slide	1
7 + 8	RAA060001D-Q2	Inner Slide + outer slide assembly	1
9	C040005-Z1	Clevis Pin-(Ø5×Ø8×25mm)	1
10	C070026-Z1	Fastening Bushing-(Ø5.2×Ø8×9mm)	1
11	C010003-Z1	Link Shaft-(Ø8×30mm)	1
12	C070025-Z1	Shaft Bushing-(Ø8.2×Ø12.7×11.5L)	2
13	B020002-Z1	Fastening Bracket-(35×27×2.0T)	2
14	B020001-Z1	Link-(31×14×2.0T)	1
15	AA060044-Q2	Handrail Support	1
16	K010001	Dual Torsion-Spring-(Ø1.0)	1
17	P060219-A7	Release Lever-(147mm×44mm×52mm)	1
18	K010002	ChenChin Torsion-Spring-(Ø1.8)	1
19	K060021	Gas Cylinder	1
20	N010001	Drive Belt-(8J240)	1
21	K140057-Z9	Front Roller W/Pulley	1
22	K140043-Z3	Rear Roller	1
23	H150002	Running Deck-(1425×664×18T)	1
24	H0713200-P5	Running Belt-(560×3200×1.6T)	1
25	L030014-A1	PVC Handgrip-(Ø36×76×3.0T×266mm)	2
26	TT440173-Q2	Deck Cross Brace	3
27	K010003	Steel Cable Tension Spring-(Ø2.0)	1
28	AA060047-Q2	Folding Assembly Bracket	1
29	N050001	Wire Tie Mount	8
30	N020001	Lubricant	1
31	K020033	Steel Cable-(1080mm)	1
32	P090097-A1	Top Frame Cover-(1122×726mm)	1
33	P090096-A1	Bottom Frame Cover-(726×739mm)	1
34	G010090A (old )	Drive Motor-(A4D,2.5HP,90V,4000RPM,Ø35,650mm,Ground Wire250mm,Label:3.5HP)	1
34	G020164A (new)	Drive Motor- (YC743,2.5HP,90V,4200RPM, Ø34, 600mm, Ground Wire250mm, Label:3.5HP)	1
35	G110072	Incline Motor-(JS15A,N30128L,1400mm)	1
036-01	D020054	Motor Controller-(YJ-2300L,110V AC)	1
036-02	D022028	Adaptor-(06144/115V(115V-12V/2A+12V/1A)EI-57)	1
37	E050058	800m/m_Speed Cable (Upper)	1
38	E050079	800m/m_Incline Cable (Upper)	1
39	F090233	650m/m_Handpulse W/Cable Assembly (Red)	1
40	F090234	650m/m_Handpulse W/Cable Assembly (White)	1

41	P060065-A1	Handpulse End Cap	2
42	F020001	Breaker-(A-0710W,250/125VAC,15A)	1
43	F010002	Power Socket-(SS-7B-VDER-4.8+150mm,white,14AWG+250mm green/ yellow+100mm,black)	1
44	F030001	On/Off Switch-(RF1004-NBR4#W1AN,5mmT)	1
45	E060001	Power Cord	1
46	E010747	100m/m_Connecting Wire (Black)	1
47	E010756	350m/m_Connecting Wire (White)	1
48	E010757	350m/m_Connecting Wire (Black)	1
49	E020002	800m/m_Computer Cable (Lower/Upper)	1
50	E020073	1350m/m_Computer Cable (Lower)	1
51	E020051	1100m/m_Computer Cable (Middle)	1
52	RZ0YT50A-20	Console Assembly	1
052-01	P020338A-LZ-AT	Console Top Cover	1
052-02	P020343-A1	Console Bottom Cover	1
052-03	P170058-AC-BH	INCLINE Key (L)	1
052-04	P170058-AC-BJ	SPEED Key (R)	1
052-05	P220003-A1	Drink Bottle Holder (L)	1
052-06	P220004-A1	Drink Bottle Holder (R)	1
052-07	P170056-A1	Lower Controller Button-TPR	1
052-08	P170057-AC-BK	Button Frame	1
052-09	P170053-A9-BM	STOP Key	1
052-10	P170052-A8-BL	START Key	1
052-11	B130062	Square Magnet Stop Plate-(20×14.8×7×0.3T)	2
052-12	D021124	7.5"/9"_Console Display Board	1
052-13	D021126	Key Board-(YJ-5962-K1)	1
052-14	D021128	START Key-(YJ-5962-K4)	1
052-15	D021129	STOP Key-(YJ-5962-K3)	1
052-16	D021127	Speed Key Board-(YJ-5962-K2)	2
052-17	P020342-JH	Front Console Cover (Top)	1
052-18	P020140-A1	Front Console Cover (Bottom)	1
052-19	F030200	300m/m_Safety Switch Module W/ Cable	1
052-20	F040101-New F040002 (stock)	Fan Assembly-(RDH8025Sx2+600mm+350mm+XHP-4)	1
052-21	P250003-A1	Deflector Fan Grill	1
052-22	P250004-A1	Fan Grill Anchor	3
052-23	F050003	550m/m_Speaker W/Cable	1
052-24	F050004	200m/m_Speaker W/Cable	1
052-25	F110204	Amplifier Controller-(YJ-8509-1)	1
052-26	D020533	300m/m_Sound Board W/Cable (Red)	1
052-27	D020534	500m/m_Sound Board W/Cable (White)	1
052-28	D020501	300m/m_W/Receiver, HR	1
052-29	P060060-A1	Fan Grill Anchor	3
052-30	J396811	3.5 × 32m/m_Sheet Metal Screw	8
052-31	E060502	600m/m_Amplifier Cable	1
052-32	P020340-A1	Speaker Cover (L)	1
052-33	P020341-A1	Speaker Cover (R)	1
052-36	P020344-LY	Console Bottom Cover	1
052-37	J397003	3 × 10m/m_Sheet Metal Screw	2
052-38	B130158-Z3	Speaker Iron Net (L)	1
052-39	B130159-Z3	Speaker Iron Net (R)	1
052-40	E040010	400m/m_Console Ground Wire	1

052-43	P020256	LCD Transparent Piece-(115×202×2T)	1
052-44	P060423	7.5" _ Water-resist Rubber	1
052-45	P020339-AC	Book Rack	1
53	P010115-A1	Motor Top Cover	1
53	RP010115-A1	Motor Top Cover + logo plate	1
54	N110007A	300m/m _ Speed Adjustment Switch W/Cable	1
55	N110002A	300m/m _ Incline Adjustment Switch W/Cable	1
56	P060019-A1	Cushion-(M8×Ø30×35mm)	4
57	P050002-A1	Transportation Wheel (A)-(Ø75×35L)	2
58	P050007-A1	Transportation Wheel (B)-(Ø62×Ø32×30L)	2
59	P080007B-A1	Foot Rail Cap (L)	1
60	P080008B-A1	Foot Rail Cap (R)	1
61	P050005-A1	Front Transportation Wheel-(Ø60×35L)	2
62	P040134-A1	Square End Cap-30×30m/m	2
63	P070142-A1	Left Handgrip Side Cap (Top)	1
65	P070143-A1	Left Handgrip Side Cap (Bottom)	1
66	P070144-A1	Right Handgrip Side Cap (Top)	1
67	P070145-A1	Right Handgrip Side Cap (Bottom)	1
68	P030066-A1	Rear Adjustment Base (L)	1
69	P030067-A1	Rear Adjustment Base (R)	1
70	P060021-A1	Motor Cover Anchor(D)	2
71	P060221-A1	Ø24 × Ø10 × 3T _ Nylon Washer (A)	4
72	P060206-A1	Ø50 × Ø13 × 3T _ Nylon Washer (B)	2
73	P060018-A1	Adjustment Foot Pad-(Ø37mm×3/8")	2
74	E040026	1000m/m _ Ground Wire (Black)	1
75	N100028-A5	Trapezoidal Safety Key	1
76	B134000-Z1	Belt Guide-(130×25×70H×1.5T)	2
77	C070031-Z4	Wheel Sleeve-(Ø10×Ø14×35.5mm)	4
78	F030191	1200m/m _ Sensor W/Cable	1
79	M010008C-Z0	Aluminum Foot Rail-(90×17×1380mm)	2
80	J071522C1-Y3	1/2" × 23m/m _ Carriage Bolt	2
81	J011523C1-Y3	1/2" × 60m/m _ Hex Head Bolt	2
82	J011006T1-Y3	3/8" × 1-1/2" _ Hex Head Bolt	1
83	J013514S1-Y3	M10 × 65m/m _ Hex Head Bolt	1
84	J011006-Y3	3/8" × 1-1/2" _ Hex Head Bolt	1
85	J011004-Y3	3/8" × 1" _ Hex Head Bolt	4
86	J341008-Y3	3/8" × 2" _ Flat Head Socket Bolt	2
87	J020504-Y3	5/16" × 1" _ Button Head Socket Bolt	2
88	J020511A-Y3	5/16" × 2-3/4" _ Button Head Socket Bolt	2
89	J013012-Y3	M8 × 60m/m _ Hex Head Bolt	1
90	J033016-Z4	M8 × 80m/m _ Socket Head Cap Bolt (Blackfast)	2
92	J043005-Y3	M8 × 25m/m _ Flat Head Countersink Bolt	2
93	J354001-Z1	M3 × 10m/m _ Phillips Head Screw	1
94	J092004-Z1	M5 × 20m/m _ Phillips Head Screw	1
95	J043009A-Y3	M8 × 45m/m _ Flat Head Countersink Bolt	6
96	J020524A-Y3	5/16" × 42m/m _ Button Head Socket Bolt	1
97	J139161-Y3	M5 × 5.0T _ Nyloc Nut	1
98	J139111-Y3	1/2" × 8.0T _ Nyloc Nut	4
99	J139011-Y3	3/8" × 7.0T _ Nyloc Nut	3
100	J139061-Y3	5/16" × 6.0T _ Nyloc Nut	3
101	J139261-Y3	M8 × 7.0T _ Nyloc Nut	1
102	J129021-Y3	3/8" × 7.0T _ Nut	3

103	J129221-Z1	M3 × 2.5T_Nut	1
104	J210001-Y3	Ø5/16" × Ø35 × 1.5T_Flat Washer	2
105	J210008-Y3	Ø10 × Ø25 × 2.0T_Flat Washer	4
106	J210003-Y3	Ø10 × Ø19 × 1.5T_Flat Washer	6
107	J210004-Y3	Ø5 × Ø10 × 1.0T_Flat Washer	2
108	J210005-Y3	Ø5/16" × Ø18 × 1.5T_Flat Washer	3
109	J210006-Y3	Ø5 × Ø12 × 1.0T_Flat Washer	1
110	J210007-Z1	Ø5 × Ø15 × 1.0T_Flat Washer	8
111	P060404	Ø6 × Ø23 × Ø13 × 5.5T × 3.0T_Nylon Dished Washer	4
112	B130013-Z1	Ø5.5 × 27 × 60 × 1T × 2.5H_Concave Washer	4
113	J260001-Y3	Ø10 × 2.0T_Split Washer	10
114	J260002-Z1	M3_Split Washer	1
115	J270001-Z1	M5_Star Washer	4
116	J386904-Y3	4 × 12m/m_Sheet Metal Screw	4
117	J367105-Y3	5 × 16m/m_Tapping Screw	59
118	J367114-Y3	5 × 19m/m_Tapping Screw	4
119	J396801-Y3	3.5 × 6m/m_Sheet Metal Screw	2
120	J377105-Y3	5 × 16m/m_Tapping Screw	19
121	J210028-Z1	Ø4 × Ø10 × 1.0T_Flat Washer	2
122	J396804-Y3	3.5 × 12m/m_Sheet Metal Screw	52
124	J517003-Y3	3 × 10m/m_Tapping Screw	4
125	J526914-Y3	4 × 50m/m_Sheet Metal Screw	2
126	J536805-Z1	3.5 × 16m/m_Tapping Screw	8
127	J547003-Z1	3 × 10m/m_Sheet Metal Screw	2
128	J160001-Y3	M5_Speed Nut Clip	6
130	J020501-Y3	5/16" × 1/2" Button Head Socket Bolt	8
131	J330001-Y3	Combination M5 Allen Wrench & Phillips Head Screw Driver	1
132	J330002-Y3	M6 (66 × 86)_L Allen Wrench	1
133	J021007-Y3	3/8" × 1-3/4" Button Head Socket Bolt	4
134	J092001-Y3	M5 × 10m/m_Phillips Head Screw	4
135	J397002-Y3	3 × 8m/m_Sheet Metal Screw	8
136	B070004-Z1	Controller Back Plate-(140×110×25×1.5T)	1
137	P070138-A1	Left Connecting Cap (Top)	1
138	P070139-A1	Left Connecting Cap (Bottom)	1
139	P070140-A1	Right Connecting Cap (Top)	1
140	P070141-A1	Right Connecting Cap (Bottom)	1
141	P010116-LY	Top Motor Cover Plate	1
142	F090001-A3	Chest Strap-(TX-1) SOLE LOGO	1
143	P010085B-A1	Front Motor Cover	1
144	P040019-A1	Handgrip End Cap-(Ø30×70)	2
145	P280010-A1	Ø13m/m_Bolt Cap	2
146	E090010	400m/m_Audio Cable	1
147	P060183-A1	Speaker Grill Anchor-(Ø12×5.5T)	6
149	N030001-A5	Drink Bottle-(CSB-501,SOLE LOGO)	1
150	P220036-A1	Beverage Holder	1
151	J020502-Y3	5/16" × 3/4" Button Head Socket Bolt	4
152	J260008-Y3	M5 × 1.5T_Split Washer	4
153	P030071-A1	LOGO Cover (R)	1
153	RP030071A-A1	LOGO Cover (R) + poly sticker	1
154	P030070-A1	LOGO Cover (L)	1
154	RP030070A-A1	LOGO Cover (L) + poly sticker	1
155	N050002	Wire Clamp	1

156	P050034-A1	Transportation Wheel-(Ø54×25mm)	2
157	P090069-A1	Rear Roller Cover (L)-(40×38×1.0T)	1
158	P090070-A1	Rear Roller Cover (R)-(40×38×1.0T)	1
159	P060264-A1	6.5 × 26 × 10T_Rubber Foot Pad	3
160	P060550-A1	Cushion-(M8×Ø30×35mm)	2
161	P140019-A1	Frame Base Cover (L)	1
162	P140020-A1	Frame Base Cover (R)	1
163	J260007-Y3	M8 × 1.5T_Split Washer	2
164	J020501-Y3	5/16" × 1/2" Button Head Socket Bolt	2
165	J341009C1-Y3	3/8" × 2-1/4" Flat Head Socket Bolt	2
166	J139361-Y3	M10 × 8.0T_Nyloc Nut	1
167	P060252-A1	Ø4.5 × Ø25 × 15T_Rubber Foot Pad	2
168	J396805-Y3	3.5 × 16m/m_Sheet Metal Screw	6
169	B021005-Q2	Incline Motor Cover	1
170	J0080040-Y3	4 × 6m/m_Phillips Head Screw	2
X	I030171	Console overlay	1
X	I050319	Poly sticker on chain cover (sole F80)	2
X	I050319A	Console Poly sticker (sole F80)	1
X	I500051-AB	Cartons ( Top )	1
X	J99A0112	Hardware Kit- customer assembly	1